

**NEWTON EARLY CHILDHOOD PROGRAM
687 WATERTOWN STREET**

**SCHOOL BUILDING COMMITTEE MEETING
UPDATE TO COMMUNITY**

Newton Public Schools
Newton, Massachusetts

MAY 9, 2019

ARROWSTREET

10 POST OFFICE SQUARE
SUITE 700N
BOSTON, MA 02109
617.623.5555

www.arrowstreet.com

Hill International

75 SECOND AVENUE
SUITE 300
NEEDHAM, MA 02494
617.778.0900

www.hillintl.com



Agenda

- » Schedule
- » Program Summary and Design Guidelines
- » Parking Plan
- » Preferred Site Plan
- » Building Layout

**NEWTON EARLY CHILDHOOD PROGRAM
687 WATERTOWN STREET**

**SCHOOL BUILDING COMMITTEE MEETING
UPDATE TO COMMUNITY**

Newton Public Schools
Newton, Massachusetts

MAY 9, 2019

ARROWSTREET
10 POST OFFICE SQUARE
SUITE 700N
BOSTON, MA 02109
617.623.5555

www.arrowstreet.com

Hill International
75 SECOND AVENUE
SUITE 300
NEEDHAM, MA 02494
617.778.0900

www.hillintl.com

Newton Early Childhood Program (NECP)

City Wide Integrated Pre School Educational Program

- » Program currently located at former Aquinas College (150 Jackson Road)
- » Serves ages 2.9 years old to under 6 years old
- » Classroom based and related services provided to students
- » Approximately 65 - 70% of NECP students have Individualized Education Plans (IEPs)
- » Due to the nature of the program, enrollment increases throughout the school year
- » The NECP group size for integrated classrooms is limited to a total of 16 students per classroom; two sub-separate classrooms have a limit of 9 students



Meetings to Date – 2019

- » Department of Public Works Transportation Division – 3/13
- » School Building Committee – 1/31, 3/14, 4/4, 5/9
- » Newton Engineering Department Site/Civil Plan Review – 3/21
- » Development Review Team – 2/27, 3/27
- » Design Review Committee – 2/13, 3/13, 4/10, 5/1
- » Working Group Meetings – 1/24, 2/7, 2/21, 3/7, 3/21, 4/4, 4/11, 5/2
- » Public Buildings – 3/1, 3/15, 4/23, 4/29
- » Public Facilities – 4/17
- » Conservation Commission – 5/9

5-58 Site Plan Approvals Schedule – 2019

February 13	Design Review Committee (DRC)
February 27	Development Review Team (DRT)

March 13	DPW - Transportation Division
March 13	Design Review Committee (DRC)
March 14	LE - NECP School Building Committee
March 27	Development Review Team (DRT) Meeting

April 4	LE - NECP School Building Committee
April 10	Design Review Committee (DRC)
April 17	Public Facilities Committee - Update

TODAY →	May 1	Design Review Committee (DRC)
	May 9	LE - NECP School Building Committee - Community Update
	May 9	Conservation Commission
	May 15	Public Hearing Docket & Public Notices Issued

June 5	Public Facilities Committee
June 19	Public Facilities Committee
June 24	Finance Committee

July 8	City Council/ School Committee Meeting
--------	--

JANUARY 2021
687 WATERTOWN ST
OCCUPANCY

Program Summary and Design Guidelines

Projected NECP at 687 Watertown Street

Exterior/ Site

- » Outdoor age appropriate playground
- » Car-centric due to nature of program
- » Vans operation: 12 - 15 Vans
- » Parent/ guardian vehicles: 45 - 65
- » Staff vehicles: 85 - 100

Building/ Program

- » Building Size: 38,000 SF on 3 levels
- » Remove modulars
- » Occupancy:
 - 305 total students (ages 2.9 to under 6 years old)
 - 104 Special needs
 - 90 Typically developing
 - 111 Related services85 - 105 Staff
- » Hours of Operation:
 - Entry 8:30am to 9:00am
 - Dismissal 12:00 to 12:30pm, 1:30pm, and 2:30pm
- » 14 - 18 Classrooms

Features/ Goals

- » Improve pick-up/ drop off and entry to provide access and security for families and caregivers
- » Design with regard with understanding the mobility and sensory needs of population
- » Design for inclusiveness and spaces for specialists adjacent or within classrooms
- » Create shared specialist offices to foster collaboration and sharing between teachers

NECP Site Circulation

Unique Features to the City wide Integrated Preschool Program

- » No yellow buses
- » Students are **2.9 to under 6 years old**, which are escorted into and picked up at the classroom
- » All transportation provided by NPS is required to be door-to-door specialized van services
- » **70 - 110 students** are transported by specialized vans, increasing throughout the year
- » At peak times, there are **10 - 12 specialized vans** required to pick up students
- » Specialized vans, just like yellow buses, require **full traffic stop** while loading and unloading students
- » All students arriving by specialized van transportation are in **5-point restraint booster seats**, requiring additional loading and unloading time
- » The NECP school schedule has **varied times and schedules** (e.g., half day, afternoons only, services only)
- » There are **two scheduled van drop off times** in the morning
- » Drop offs and pick-ups are scheduled every **15-30 minutes** from noon to 2:30 p.m.
- » **Role model students** arrive with and are picked by parents/ guardians (mostly arriving by car)
- » Proximity of **Day Middle School** adds to potential peak traffic congestion/delays for specialized vans along Albemarle Road

687 Watertown Street



687 Watertown Street



687 Watertown Street

Existing Horace Mann Site Circulation



687 Watertown Street NECP Parking Plan

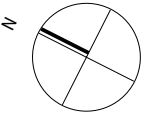

» Projected parking demand:

85 - 100 Staff

45 - 65 Parents/ Guardians

» Available parking:

(Approx. 265 total existing)

18 parking lot (Staff)

93 head in east side of Albemarle
down to Gath

72 parallel on west side of Albemarle
down to Gath

80+ parallel on Edinboro, Page,
Walker, Brookside, and
Albemarle (South of Watertown)



Site Trip Generation Comparison

Existing Horace Mann School vs. Proposed NECP

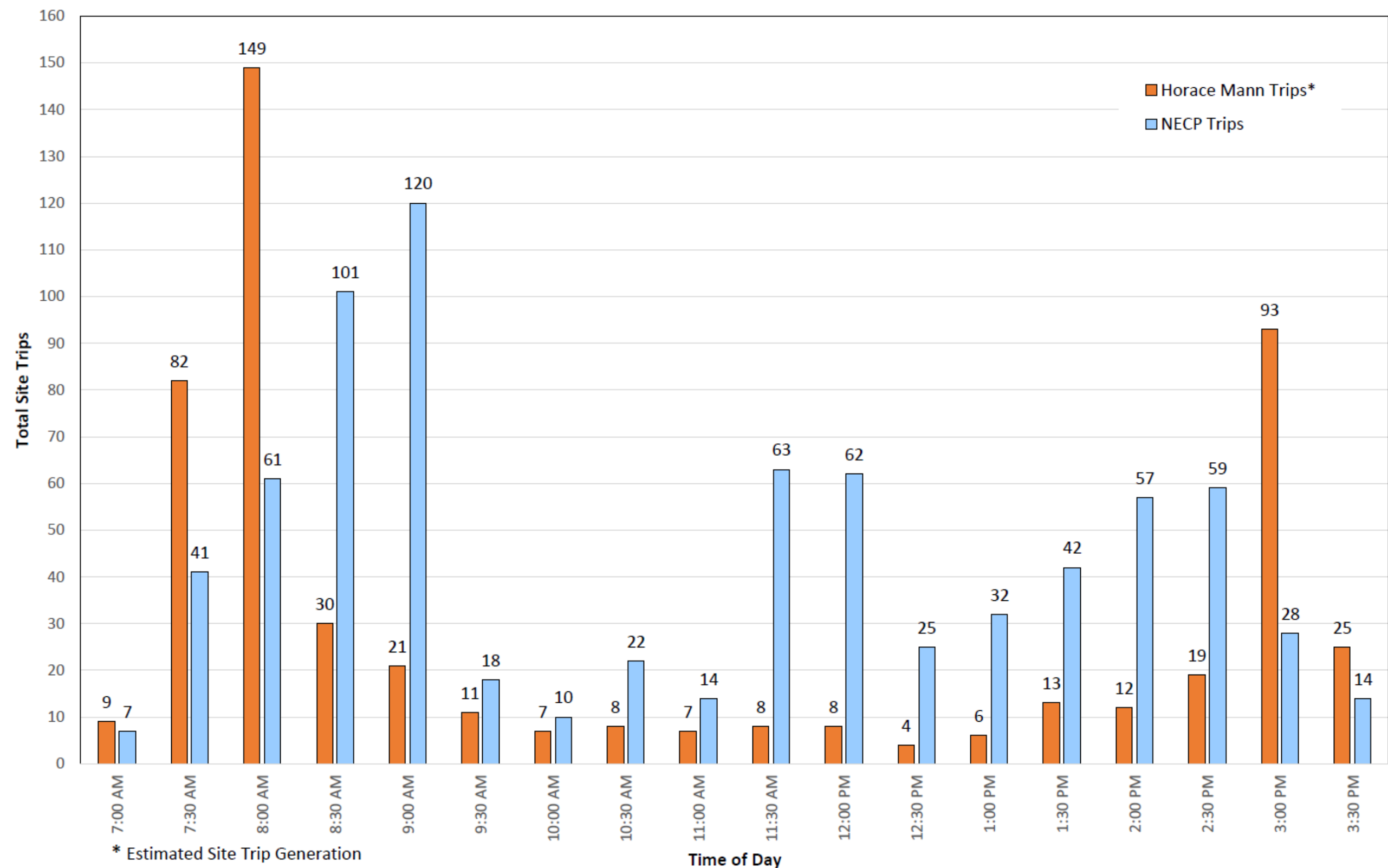

687 Watertown Street Developed Site Option

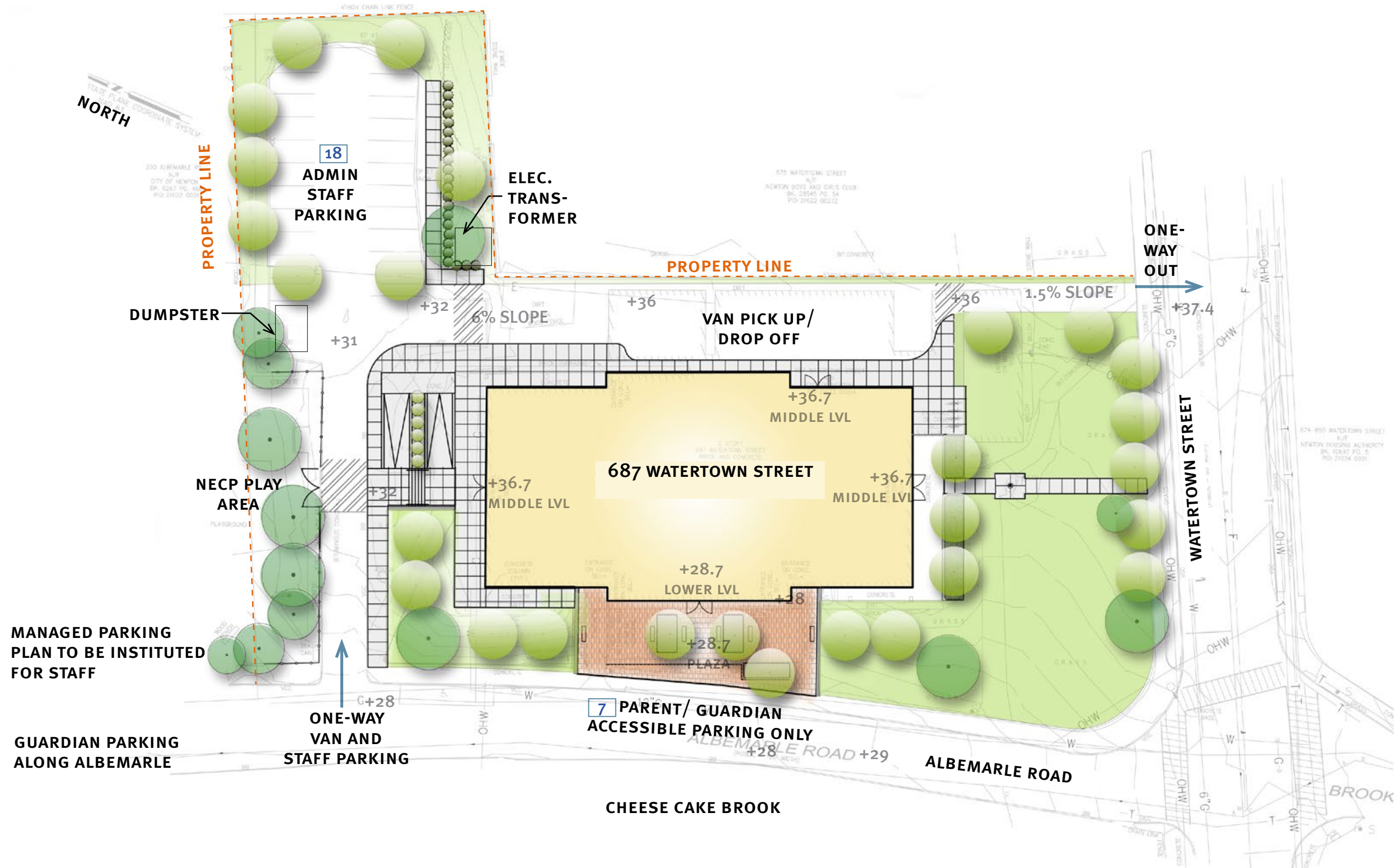

687 Watertown Street

Site Circulation

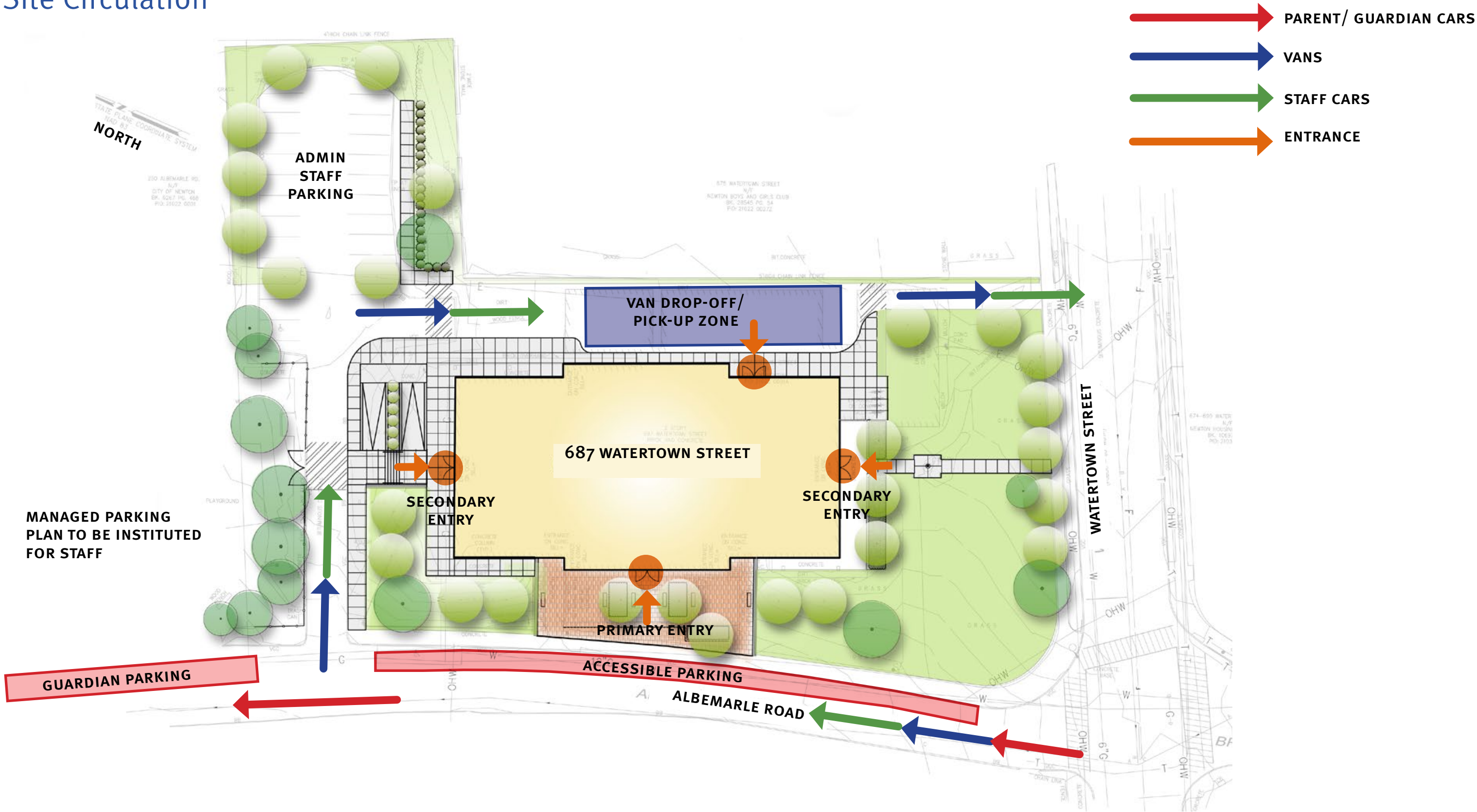

687 Watertown Street Playground Concept



RUBBER SURFACING EXAMPLES



EQUIPMENT FROM 150 JACKSON



687 Watertown Street

Developed Option

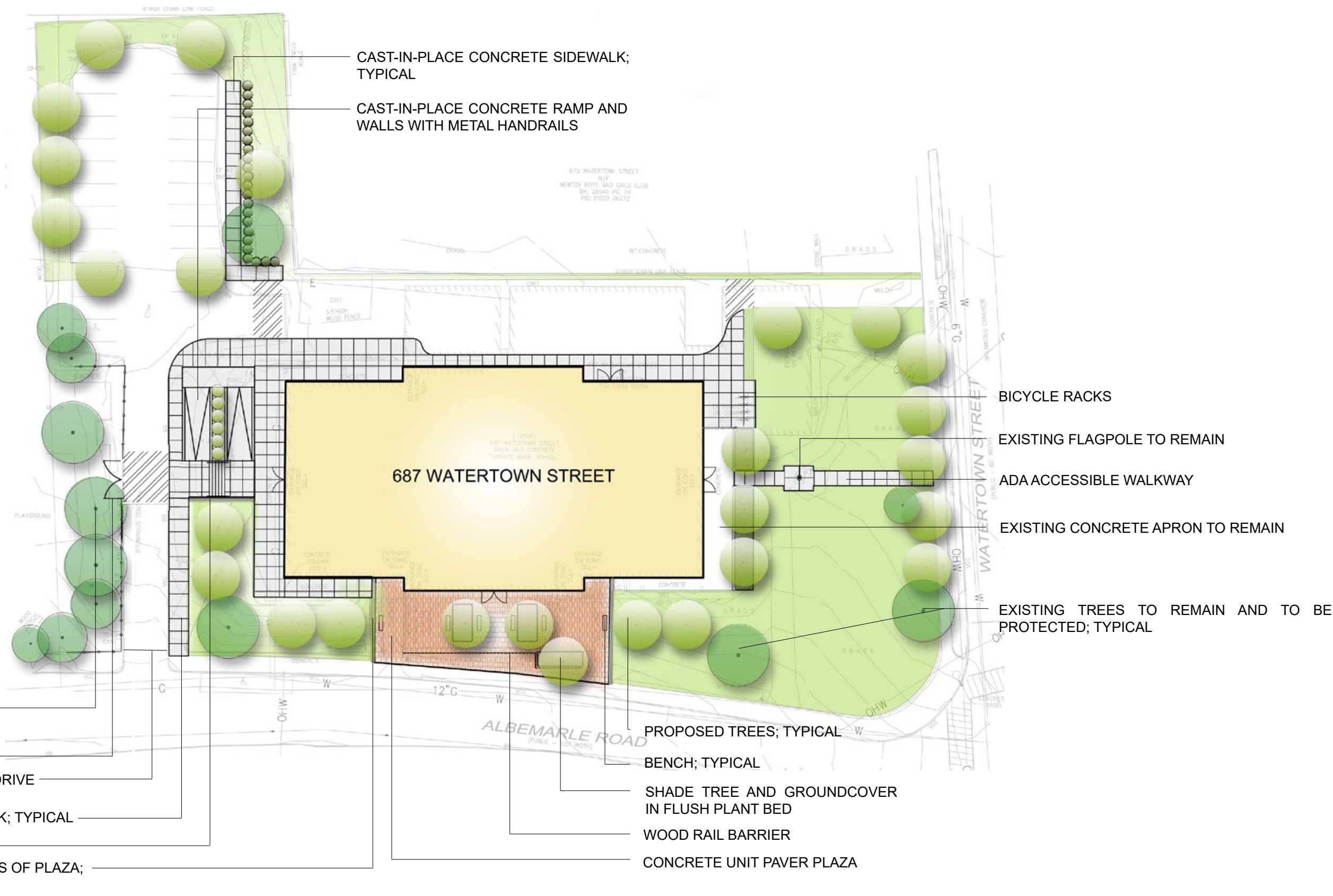

Newton Early Childhood Program

Lower Level (Level o) – Fit Plan

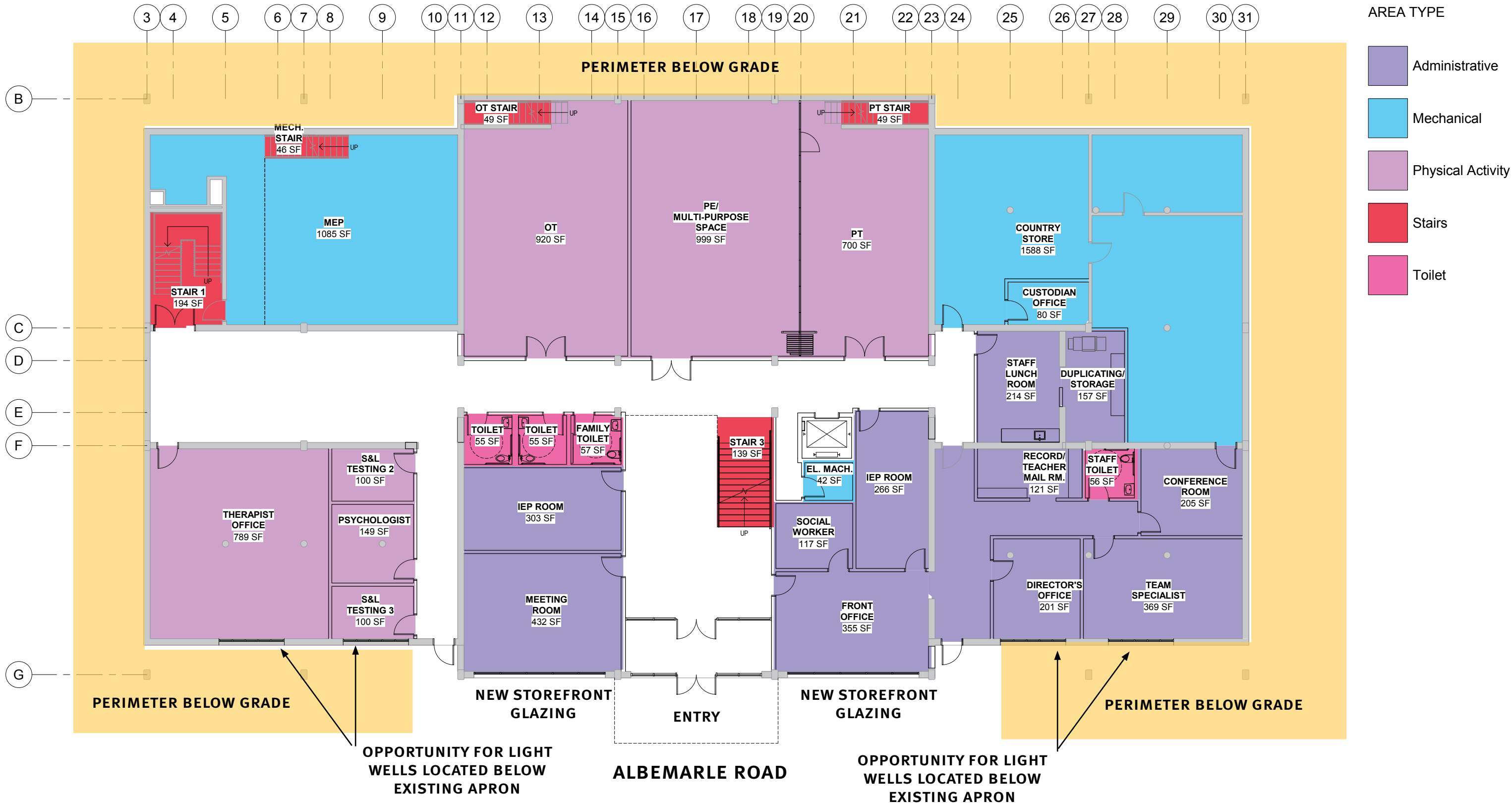

Newton Early Childhood Program

Middle Level (Level 1) – Fit Plan

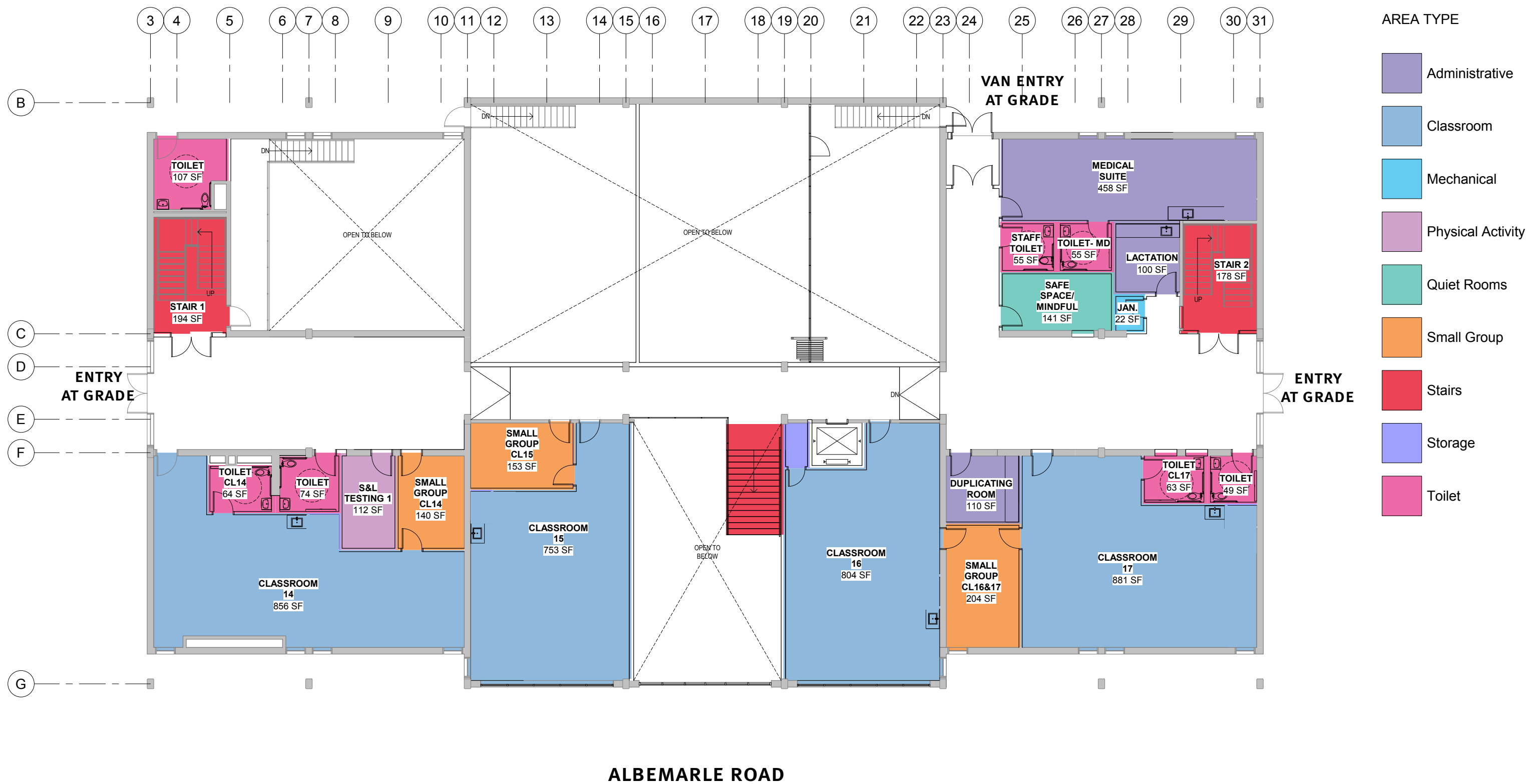

Newton Early Childhood Program

Upper Level (Level 2)– Fit Plan

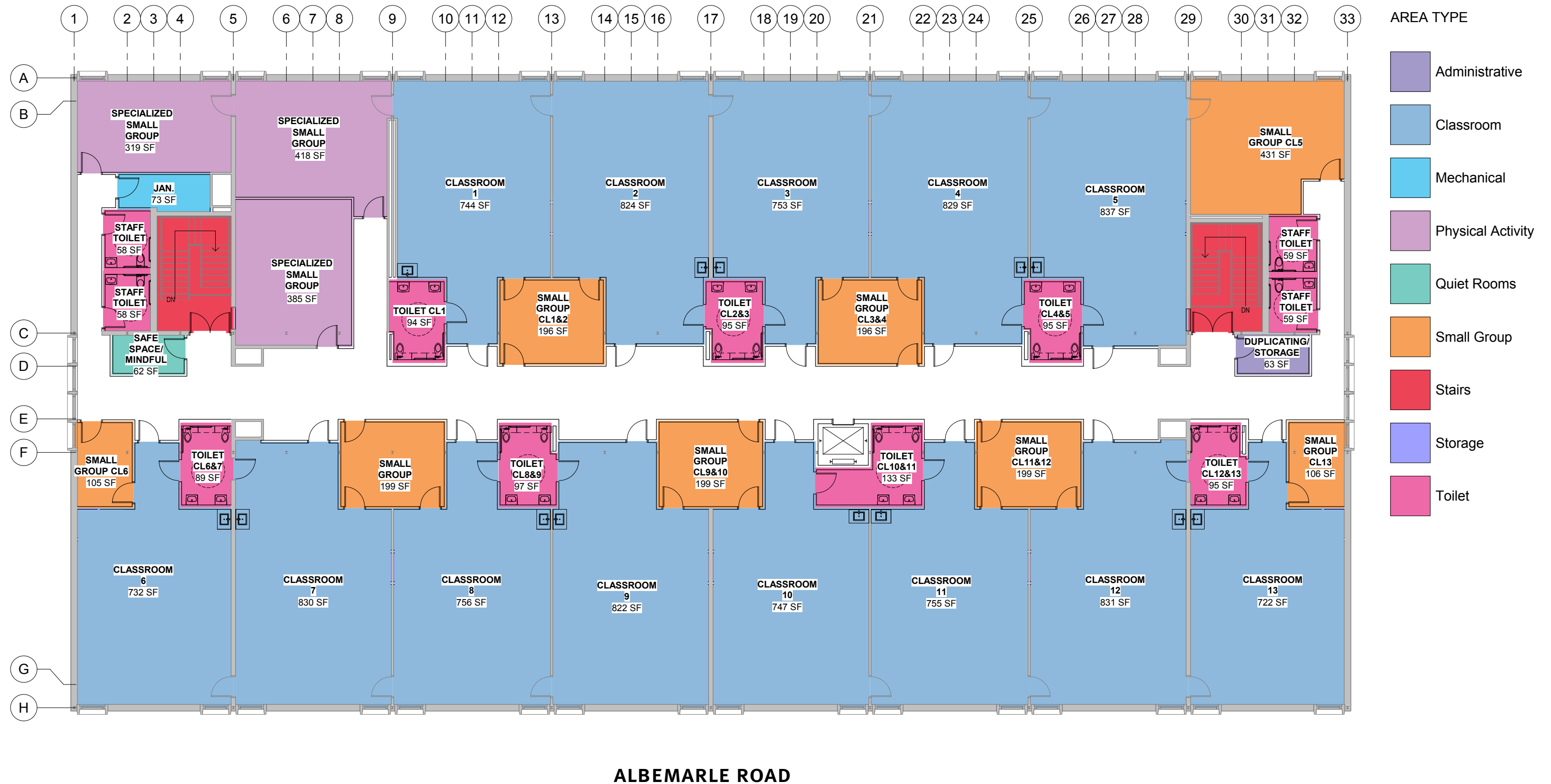

Discussion

www.newtonma.gov/gov/building/capital_projects

www.lincolneliot-necp-projects.com

**NEWTON EARLY CHILDHOOD PROGRAM
687 WATERTOWN STREET**

**SCHOOL BUILDING COMMITTEE MEETING
UPDATE TO COMMUNITY**

Newton Public Schools
Newton, Massachusetts

MAY 9, 2019

ARROWSTREET
10 POST OFFICE SQUARE
SUITE 700N
BOSTON, MA 02109
617.623.5555

www.arrowstreet.com

Hill International
75 SECOND AVENUE
SUITE 300
NEEDHAM, MA 02494
617.778.0900

www.hillintl.com