

**ARROWSTREET**  
HILL INTERNATIONAL

# **NEWTON EARLY CHILDHOOD PROGRAM**

PARKS AND RECREATION PRESENTATION

NEWTON, MA  
27 JANUARY 2020

**PROGRAM SUMMARY  
SITE DESIGN  
PLAYGROUND OPTIONS  
SCHEDULE OVERVIEW**



# Program Summary and Design Guidelines

Projected NECP at 687 Watertown Street

## Exterior/ Site

- » Outdoor age appropriate playground
- » Car-centric due to nature of program
- » Vans operation: 12 - 15 Vans
- » Parent/ guardian vehicles: 45 - 65
- » Staff vehicles: 85 - 100

## Building/ Program

- » Building Size: 38,000 SF on 3 levels
- » Remove modulars
- » Occupancy:
  - 305 total students (ages 2.9 to under 6 years old)
  - 104 Special needs
  - 90 Typically developing
  - 111 Related services
  - 85 - 105 Staff
- » 17 Classrooms with support spaces

## Features/ Goals

- » Improve pick-up/ drop off and entry to provide access and security for families and caregivers
- » Design with regard with understanding the mobility and sensory needs of population
- » Design for inclusiveness and spaces for specialists adjacent or within classrooms
- » Create shared specialist offices to foster collaboration and sharing between teachers

# SITE DESIGN



# 687 Watertown Street





# 687 Watertown Street





NECP  
Developed Site Plan

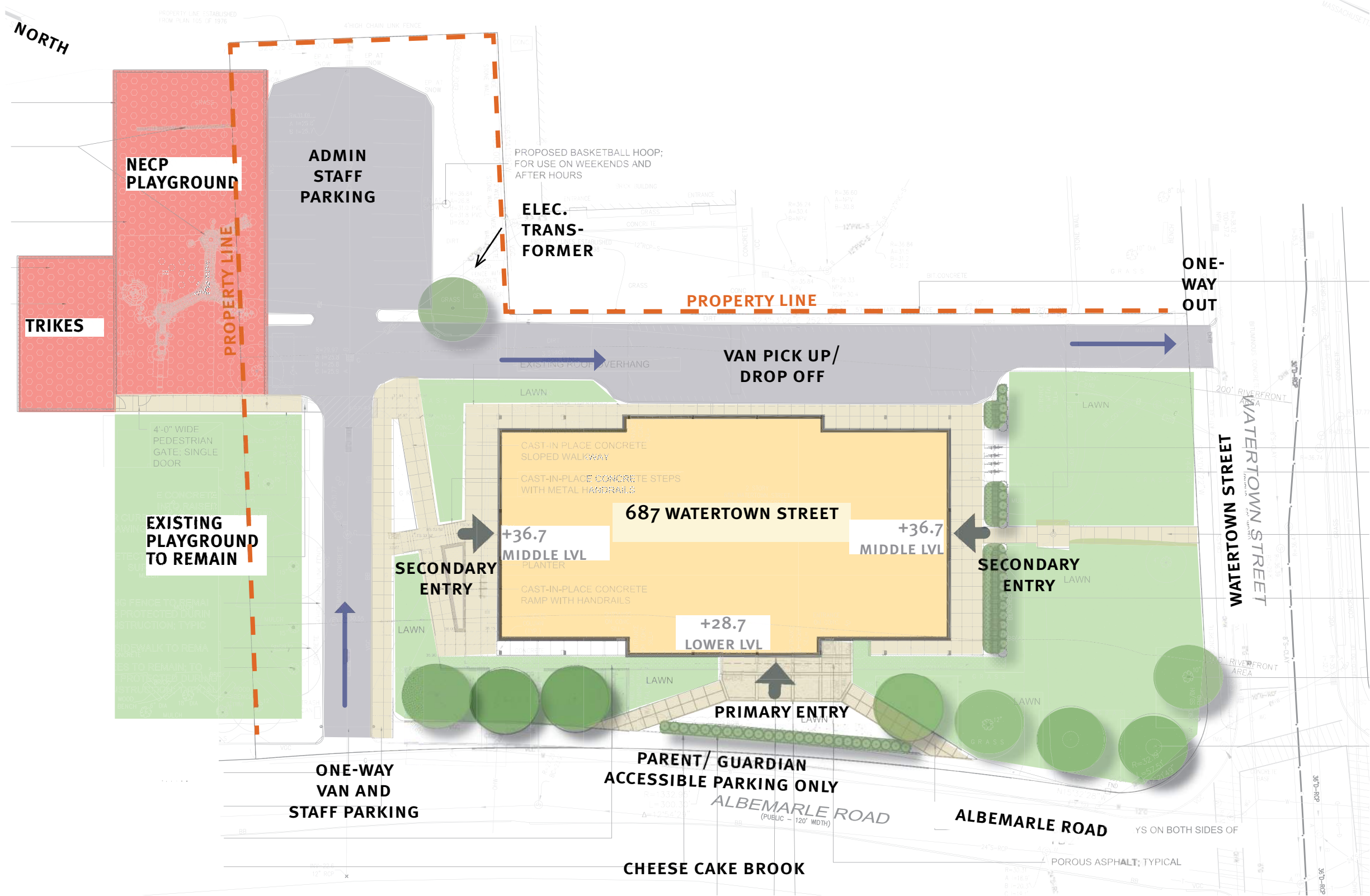

RUBBER SURFACING EXAMPLES



EQUIPMENT FROM 150 JACKSON





# NECP

## Site Aerial Perspective





# NECP

## Front Entrance





# PLAYGROUND OPTIONS











# NECP

## Playground Options

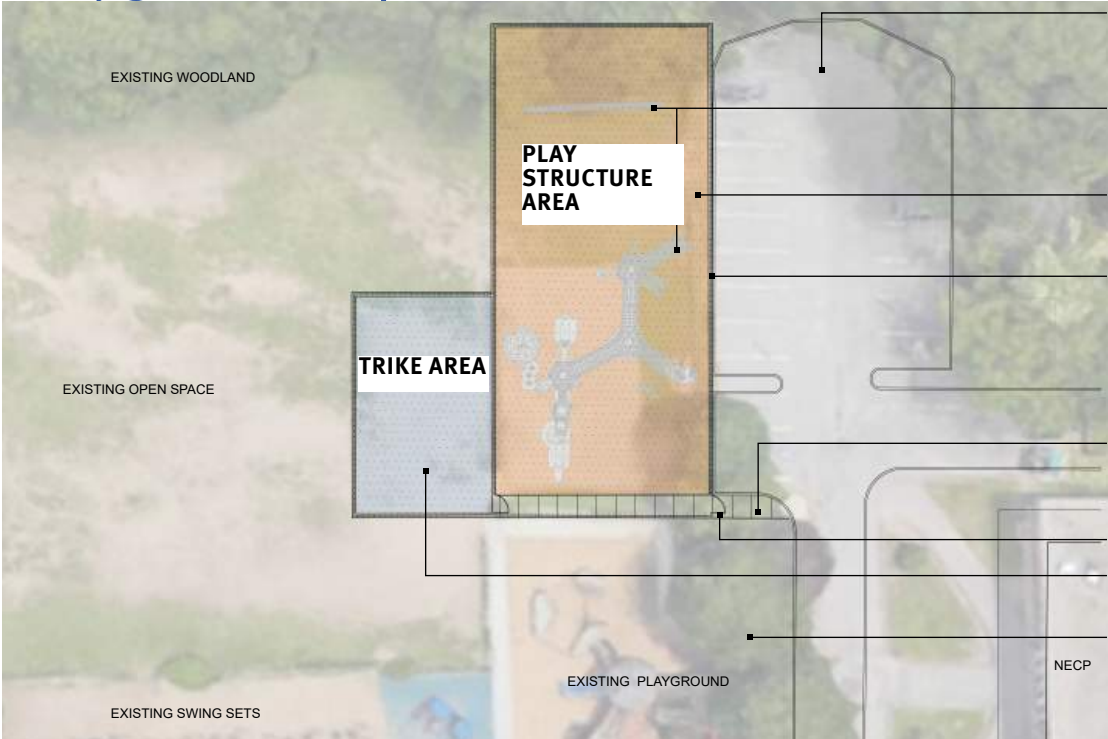

A- Original Concept

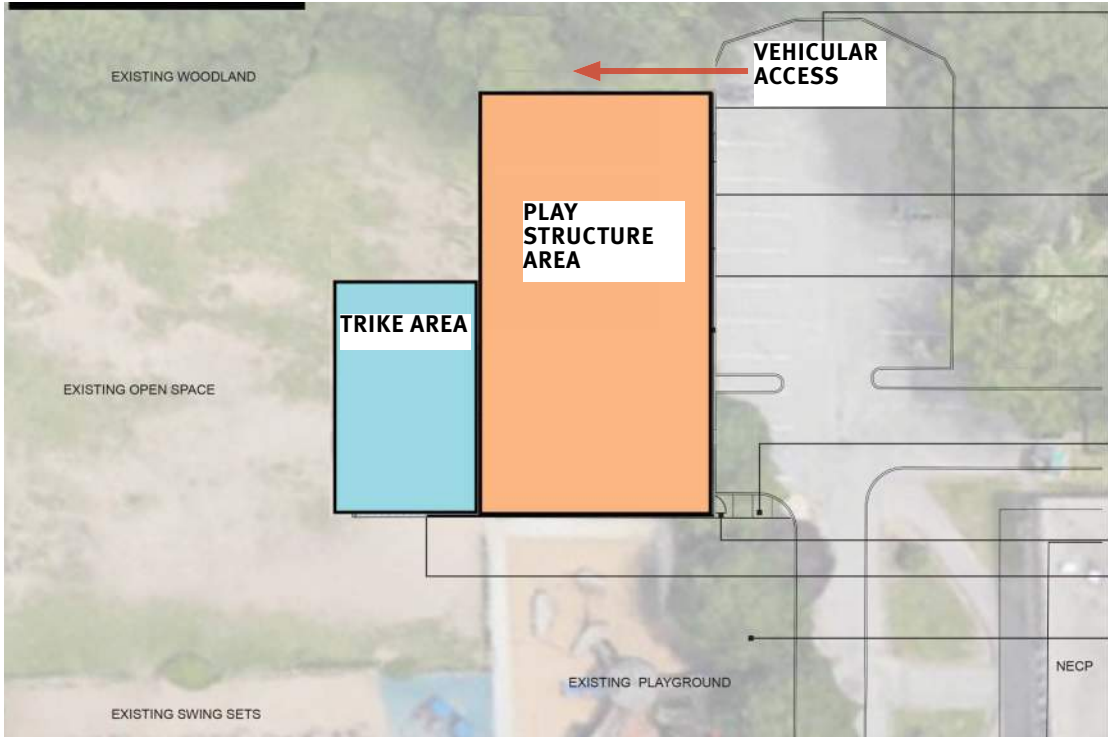

B (includes new swings)

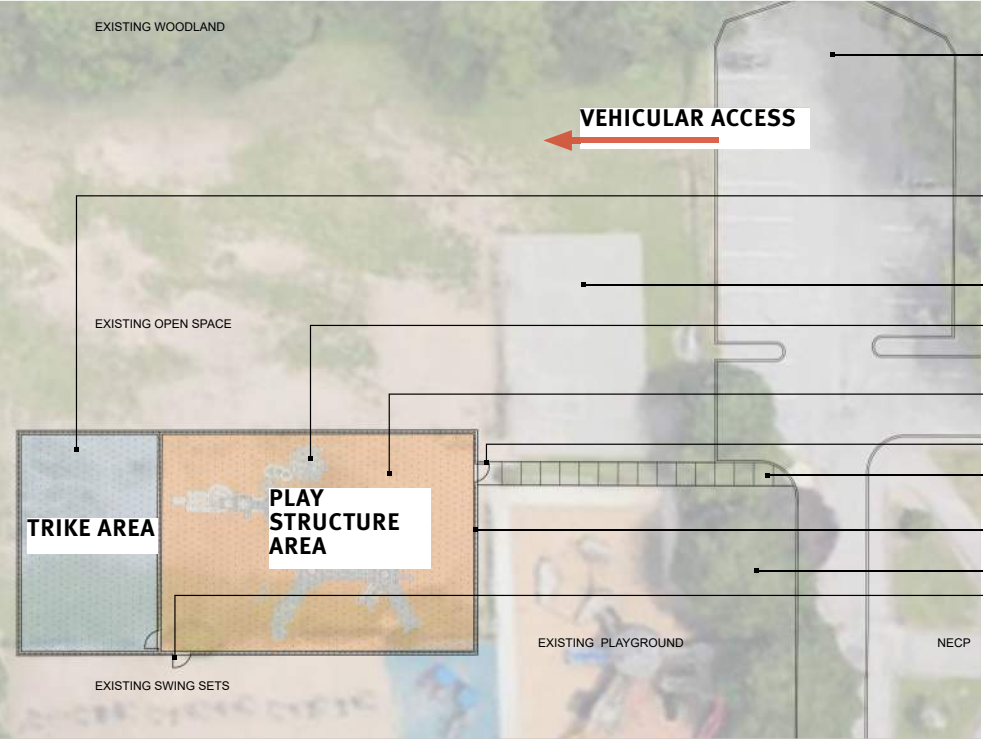

C (shared swings)

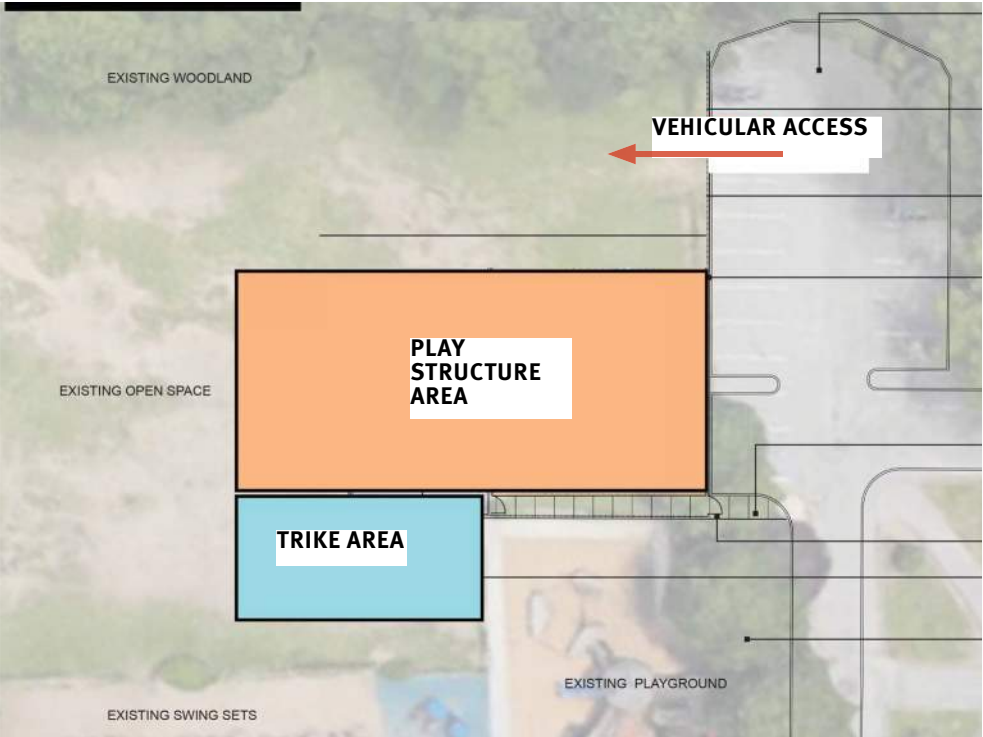

D (includes new swings)

## Playground Program

- » Relocate Play Structure (from 150 Jackson)
- » New Swings or access to swings
- » Trike Area
- » Accessbile path to play area
- » Fully Fenced
- » Vehicular Access to field

## Playground Preferences

- » Located closer to NECP parking lot
- » Dedicated swings within play area



# Project Schedule Overview



## CITY OF NEWTON | NECP PROJECT

### Project Plan & Timeline

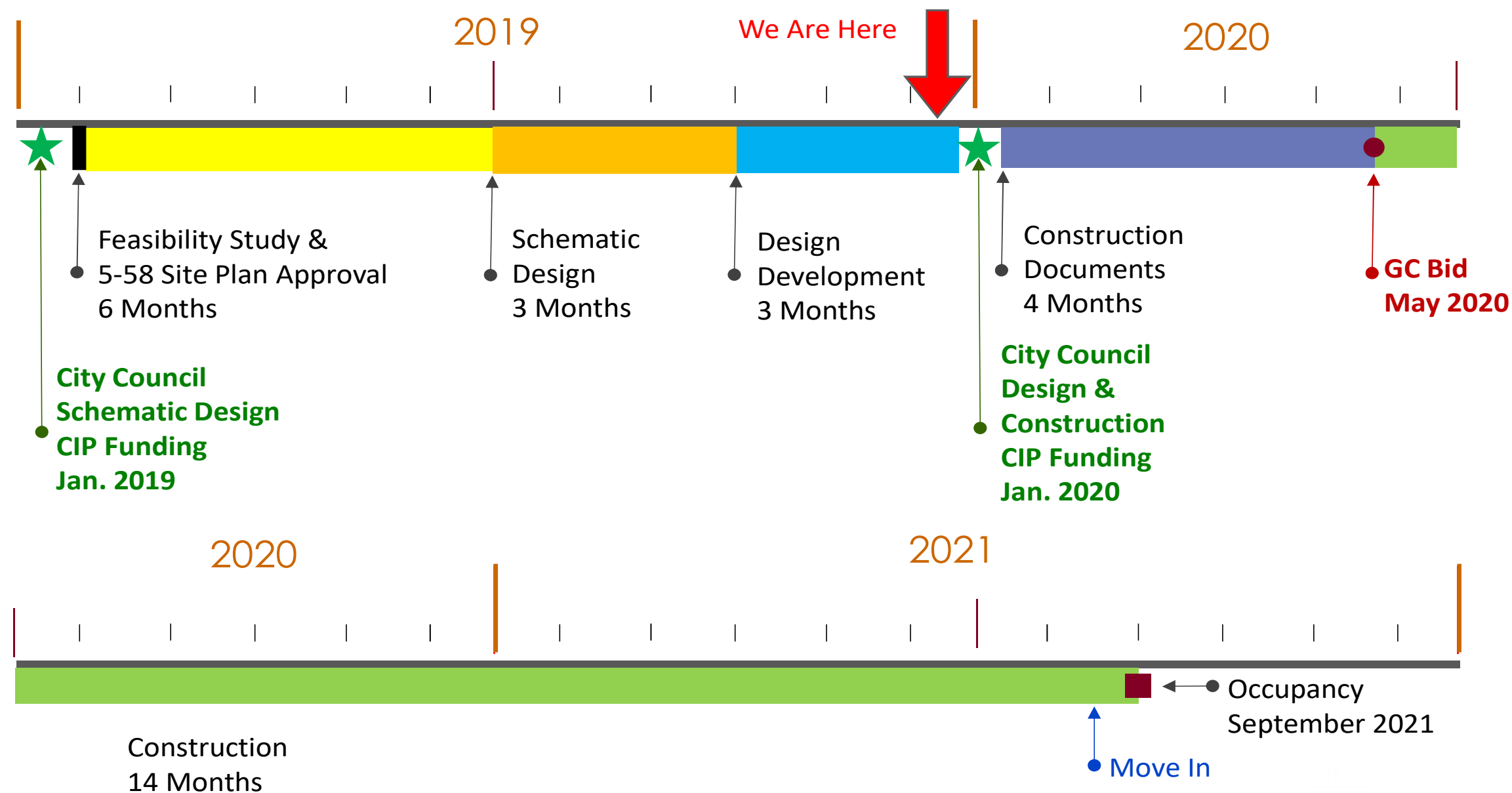

LE-NECP DRC Meeting – December 11, 2019





# DISCUSSION







# Newton Early Childhood Program

## Lower Level (Level o) – Floor Plan

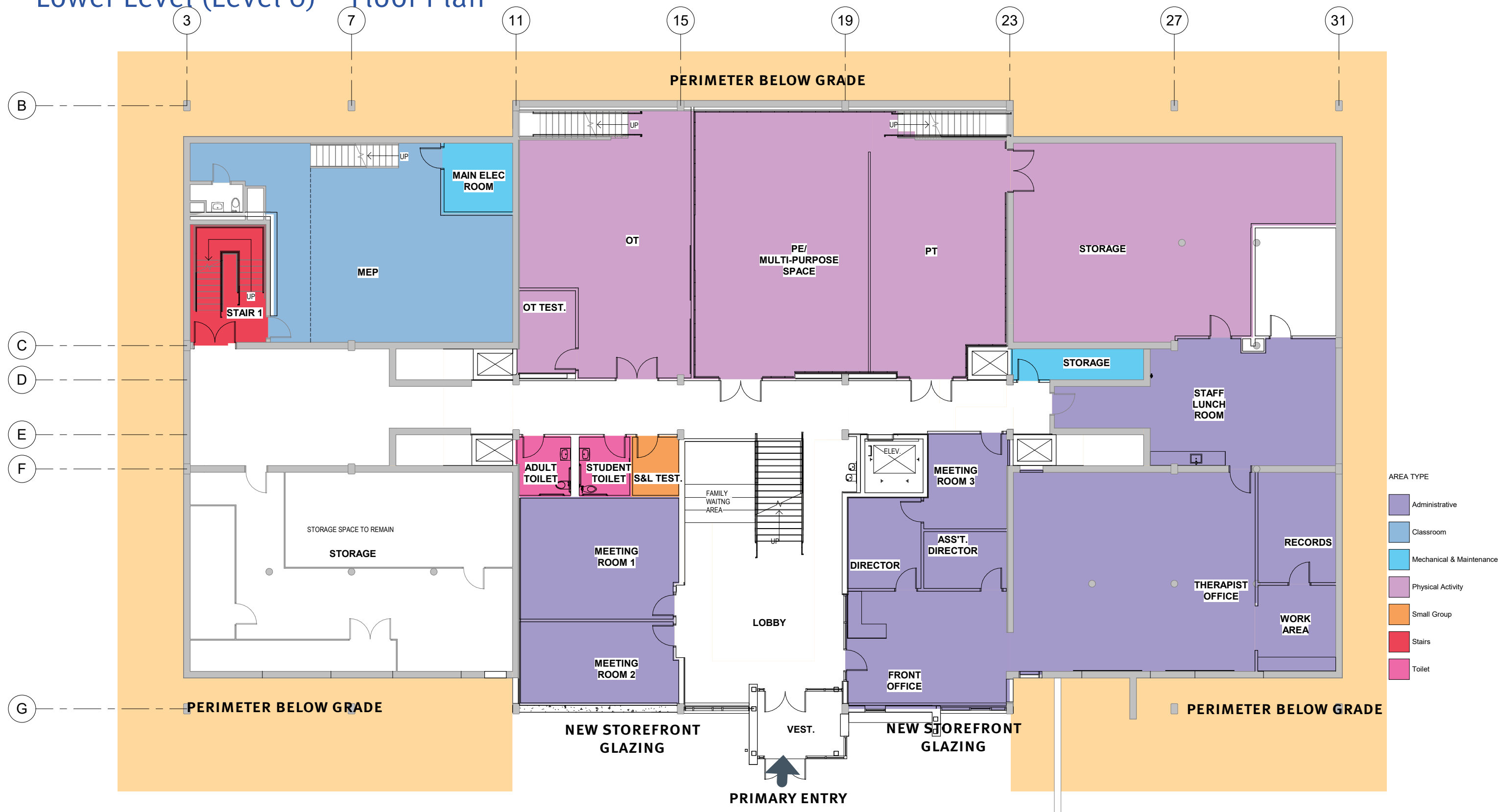



# Newton Early Childhood Program

## Middle Level (Level 1) – Floor Plan

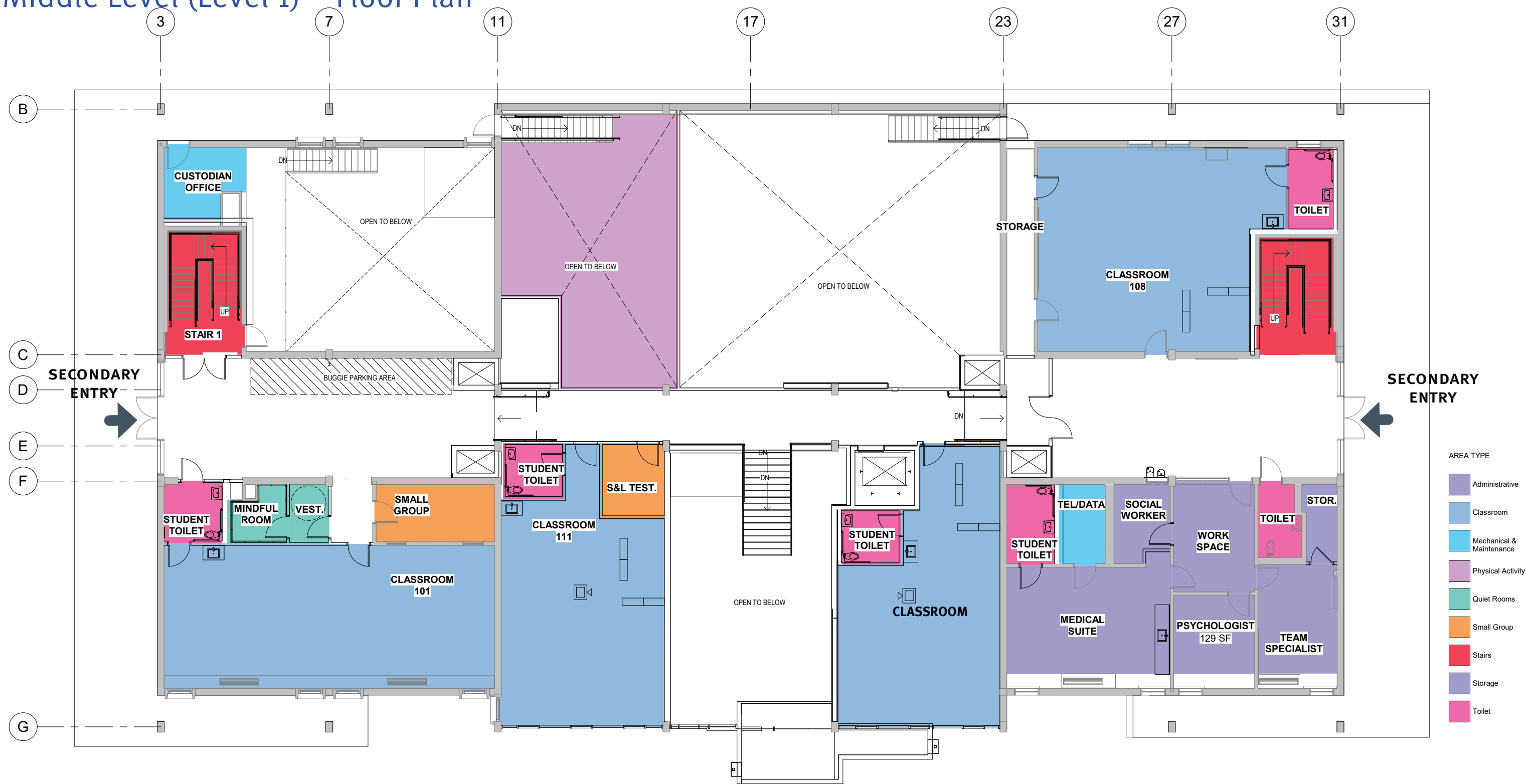



# Newton Early Childhood Program

## Upper Level (Level 2) – Floor Plan

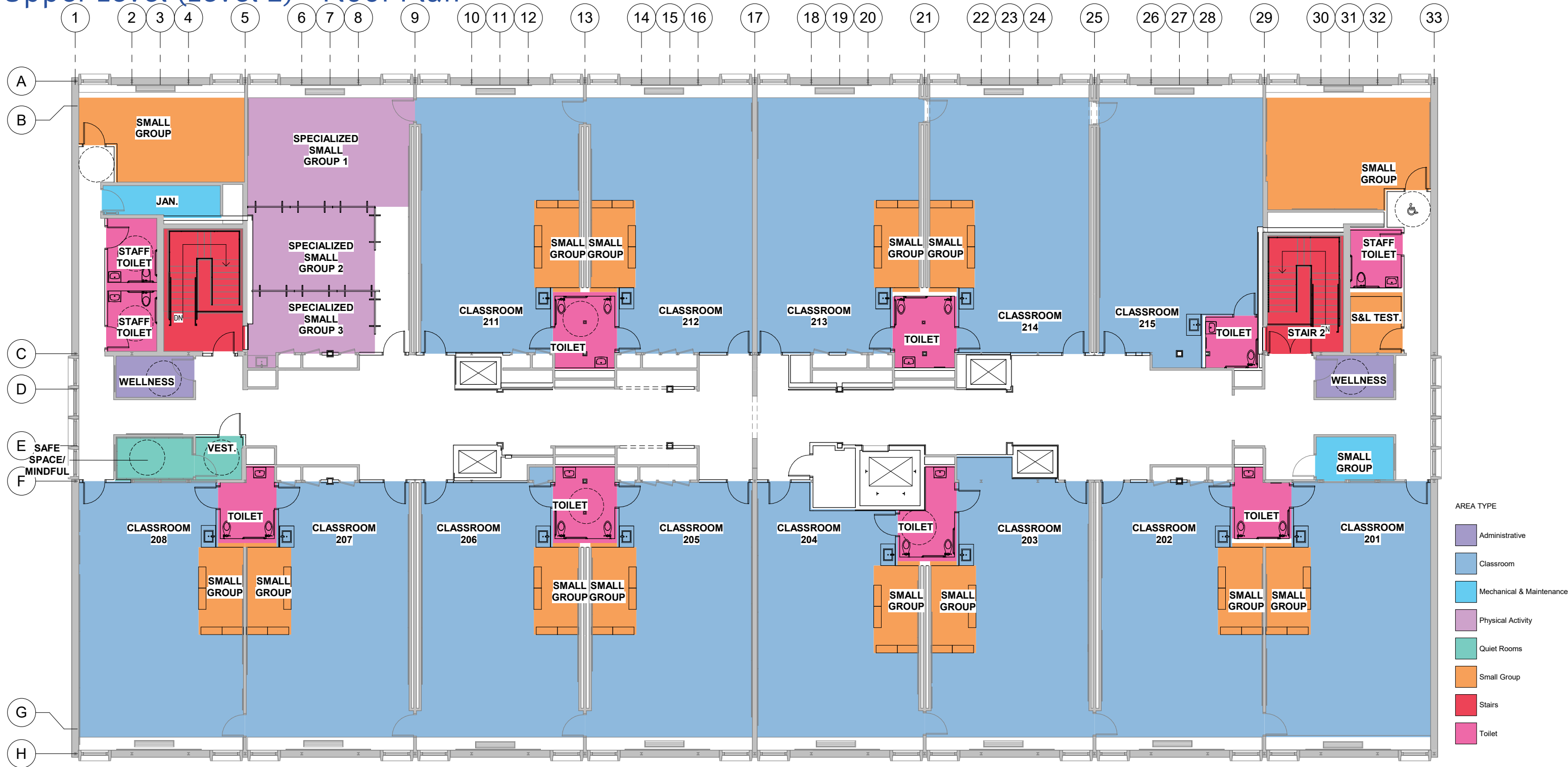



# Newton Early Childhood Program

## Upper Level Perspective





# Newton Early Childhood Program

## Upper Level Perspective





# Newton Early Childhood Program

## Lobby Perspective

